



C.E.B. IMPIANTI s.r.l.

IMPIANTI DI LAVAGGIO PER L'INDUSTRIA
WASHING PLANTS FOR INDUSTRY

**Model EWC-BW/150/A
HIGH PRESSURE (at 150 bar)
WATER WASHING EQUIPMENT
suitable for inside and outside washing
of 360L and 770L bins**



(Example picture only)



via Stab. Figliodoni, 14 - 23891 Barzanò (LC) - Italy
Tel. +39 039 958482 - Fax +39 039 9217563
www.cebimpianti.com - info@cebimpianti.com
VAT Nr. 02652530961



MAIN TECHNICAL FEATURES

Applicable to models	EWC/ EW
<i>Insulation</i>	IP55
<i>PLC</i>	SIEMENS S7/1200
<i>Cycle process time</i>	Programmable
<i>Compressed air</i>	7 Bar
<i>Supply</i>	3x400 V – 50 Hz (different on request)
<i>Installed power</i>	20 kW for internal washing / 7,5 kW for external washing / 14 (7+7) kW for heating elements
<i>Motor</i>	18,5 kW (at 250 bar) / 5,5 kW for external washing / 11 (5,5+5,5) kW for heating elements
<i>Overall dimensions</i>	(LxWxH) mm 5.000 x 2.000 x 3.000 Kg. 2.000
<i>Washing media</i>	Water / water + detergents / detergents / sanitizers
<i>Washing pressure</i>	Inside 150 bar – adjustable / outside 10 bar
<i>Flow</i>	61 lit/min
<i>Temperature</i>	Max 70°
<i>Washing pump</i>	High pressure pump
<i>Rinsing pump</i>	High pressure pump
<i>Emptying pump</i>	Double diaphragm at 1"
<i>Feeding pump</i>	High pressure pump
<i>Loading cage</i>	Equipped with tilting platform
<i>Sealing</i>	door
<i>Filters</i>	Nr. 2 stainless steel filters: * first one (400μ) for residual liquid * second one (200μ) for the high-pressure pump protection
<i>Washing time</i>	The cycle time can be selected by the operator. The whole cycle lasts usually between 3 to 5 minutes
<i>Safety devices</i>	Cover lowering sensor Washing liquid flow sensor Compressed air sensor Cleaning media flow sensor

**Technical features may change without prior notice.
Consult with CEB Impianti for the latest version available.**

SEALING



BIN SIZES



WASHING RESULTS (before and after)



Bin internal – before

Bin internal – after

LAYOUT (indicative)

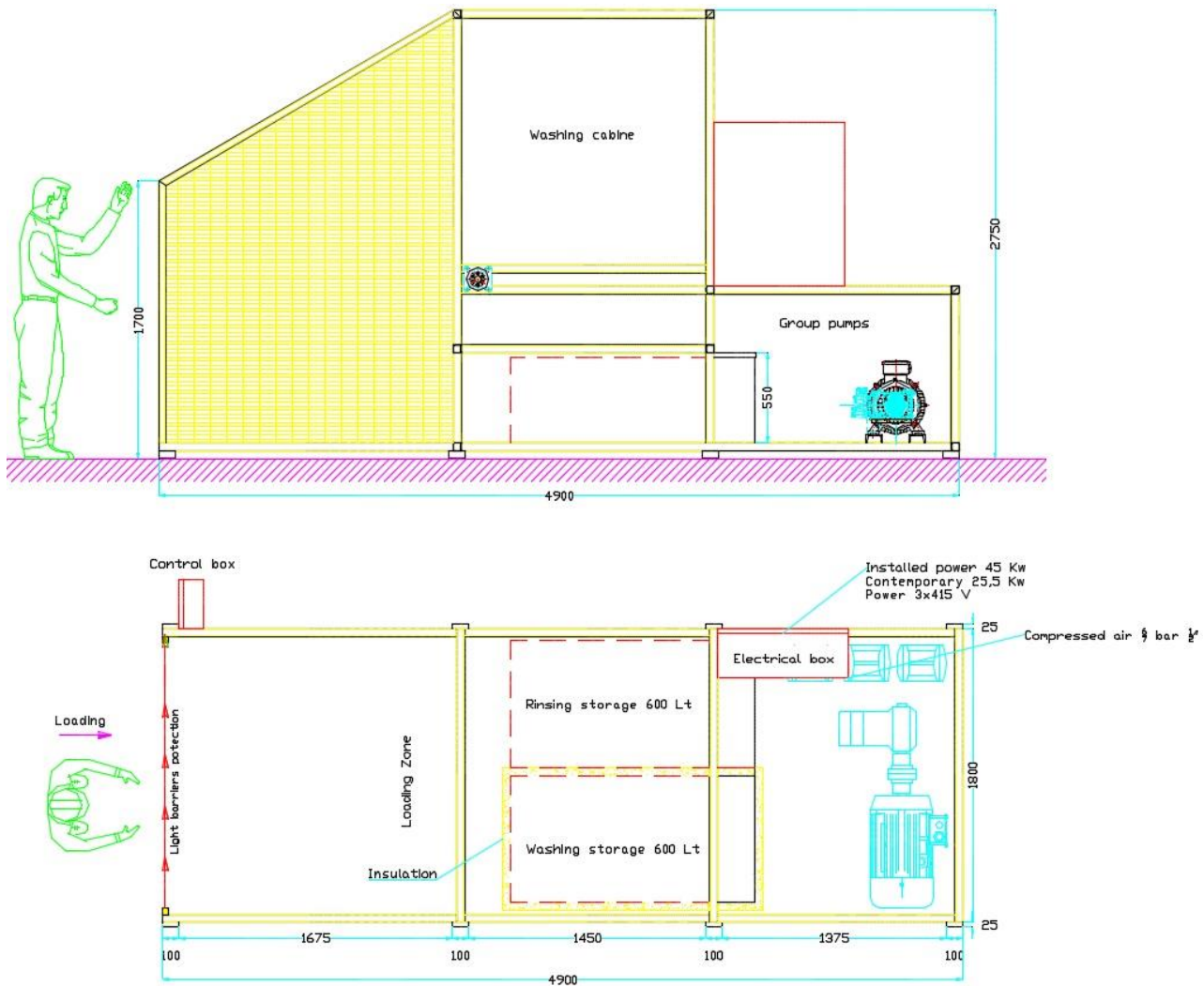

Check your technical request and the dimensions of your containers with CEB Impianti before considering the use of the present washing machine

CEB Impianti S.r.l.
via Stab. Figliodoni, 14 - 23891 Barzanò (LC) - Italy
Tel. +39 039 958482 - Fax +39 039 9217563
VAT Nr. 02652530961

February 2019 – Rev. A